



Welcome

Welcome to our second public event on our Estate Transformation Project.

This event continues our ongoing consultation with the College community and surrounding neighbours.

Following our initial public consultation in February 2025, we have carefully considered the feedback received and have continued to develop a holistic approach to our estate – one that reflects both our ambitions and the priorities of the local community.

The materials on display today – and on our website – outline how we will prepare the College for the future, while preserving the values and identity that make Mansfield special.

Members of the project team are available today to speak to you about the project, answer any questions you may have, and listen to your views.

Feedback forms are available for you to complete today or take away and return to us by freepost. If you prefer, you can complete a feedback form online by visiting www.mansfield.ox.ac.uk/estatetransformationproject/



0800 689 5209



www.mansfield.ox.ac.uk/estatetransformationproject



Freepost CONSULTATION REPLY
(no stamp required)



consultation@mansfieldproject.co.uk



About Mansfield

Mansfield is one of the 39 colleges within the University of Oxford.

An egalitarian academic community committed to sustaining and promoting intellectual and social openness, offering opportunities for individuals from all walks of life to study, thrive and experience life-changing opportunities.

We are recognised across the University of Oxford, the university sector and nationally as an outstanding leader in widening participation in world-class education,

by identifying and nurturing talent from the widest range of socio-economic backgrounds.

Mansfield became a full college of the University of Oxford in 1995; five years later, we launched a major initiative to welcome state school applicants, and by 2020 our offers to state school students had risen from 65% to over 90%.



Mansfield student demographics

Proportion of total UK students admitted	Mansfield 2021-2023	University overall 2021-2023
From state schools	93.7%	67.6%
From Acorn 4 and 5 (most socio-economic disadvantaged areas)	27.8%	15.8%
Areas of low progression to higher education	26.1%	15.7%



Background to the Estate Transformation Project

In February 2025, we shared an overview of the holistic approach we are taking to address the challenges facing our physical estate.

This included outlining our plans to focus new development on the southern area of our estate, while improvements to the North Range will ensure our heritage buildings are fit for the future and their beauty shared and celebrated by all.

We explained how we have worked with technical experts to carefully assess the South Range buildings, considering options including retention, refurbishment, adaptation and extension, as well as evaluating the carbon footprint associated with retaining or replacing the buildings.

The review showed that replacement – done once and done well – will best support the College in the long term by delivering buildings that perform significantly better environmentally, functionally and in terms of accessibility.

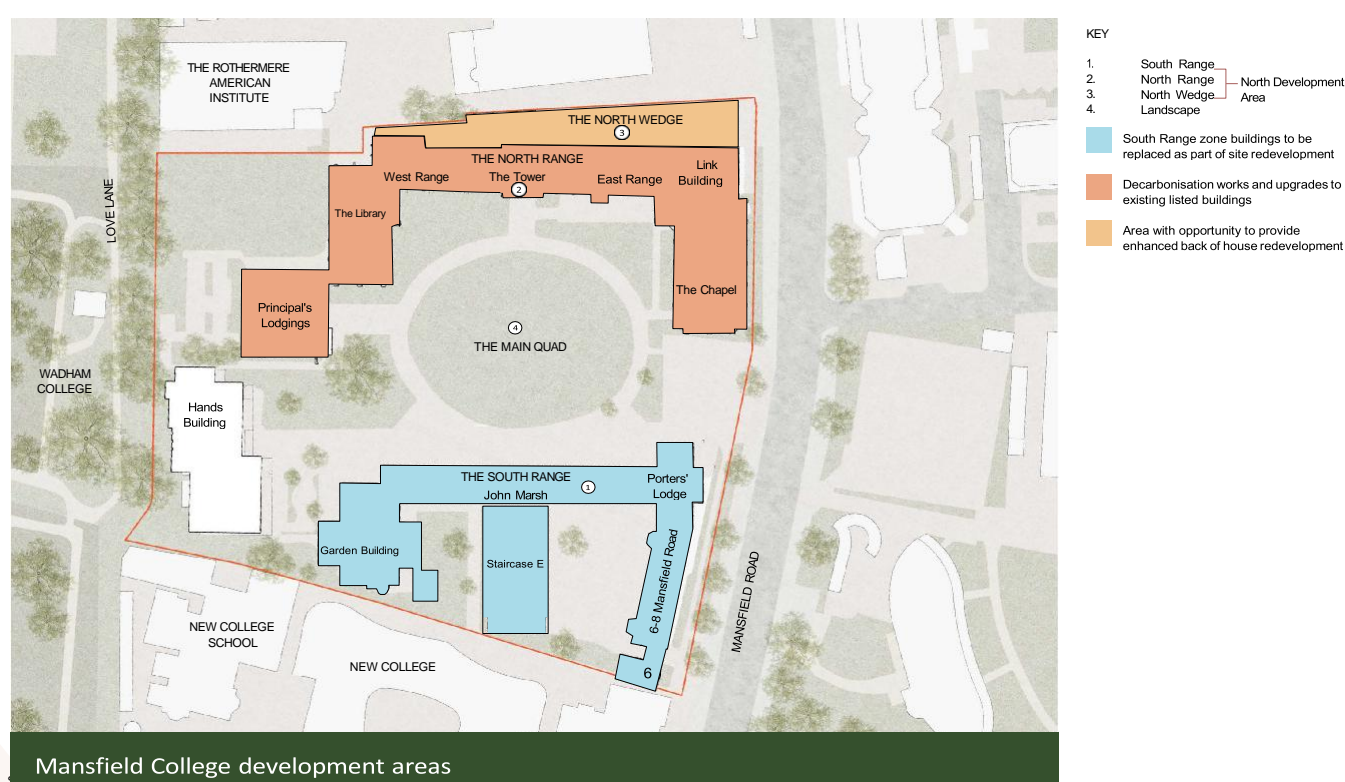

We are now pleased to share more detailed plans that illustrate how we will:



Provide more on-site student accommodation.



Offer new, inclusive and accessible community and academic spaces for our students and staff.



Enhance our historic surroundings.



Achieve our goal of being net zero carbon by 2050.



Secure the financial future of Mansfield College.



0800 689 5209



www.mansfield.ox.ac.uk/estatetransformationproject



Freepost CONSULTATION REPLY
(no stamp required)



consultation@mansfieldproject.co.uk



The South Range – completing the quad

Our evidence-based decision to replace the South Range buildings has created a once-in-a-lifetime opportunity not only to meet the College’s operational and financial needs but also to complete the Main Quad.

The plan below outlines the proposed new footprint of the South Range, replacing a series of low-performing buildings with a single, unified building that respects and enhances the historic College setting by completing the Main Quad and forming new South and West Quads.

Internally, the South Range will feature new en-suite student bedrooms, academic and non-academic offices, a new point of arrival, a more accessible Porters’ Lodge, shared student kitchens and new Junior and Middle Common Rooms (the JCR and MCR).

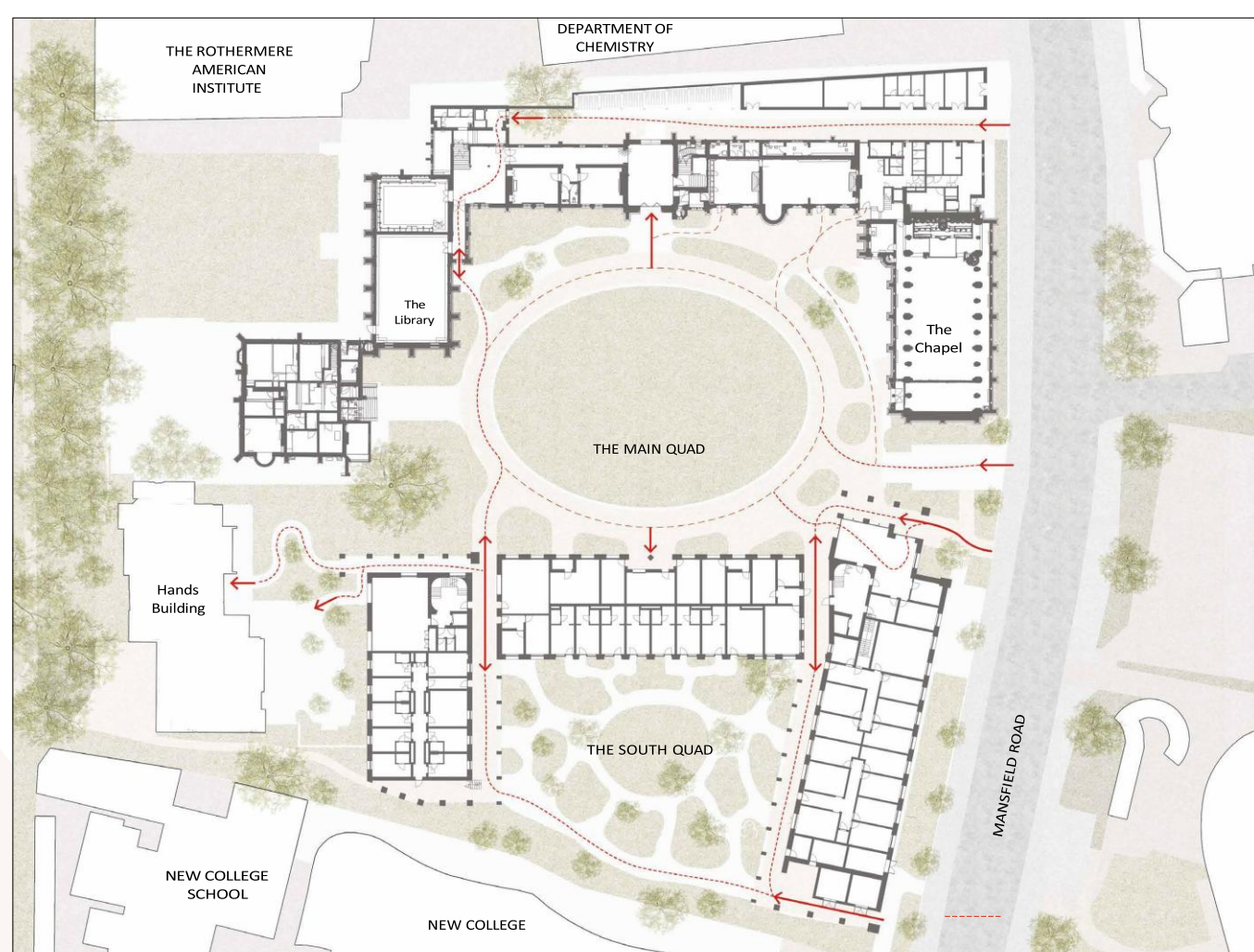

Proposed site plan

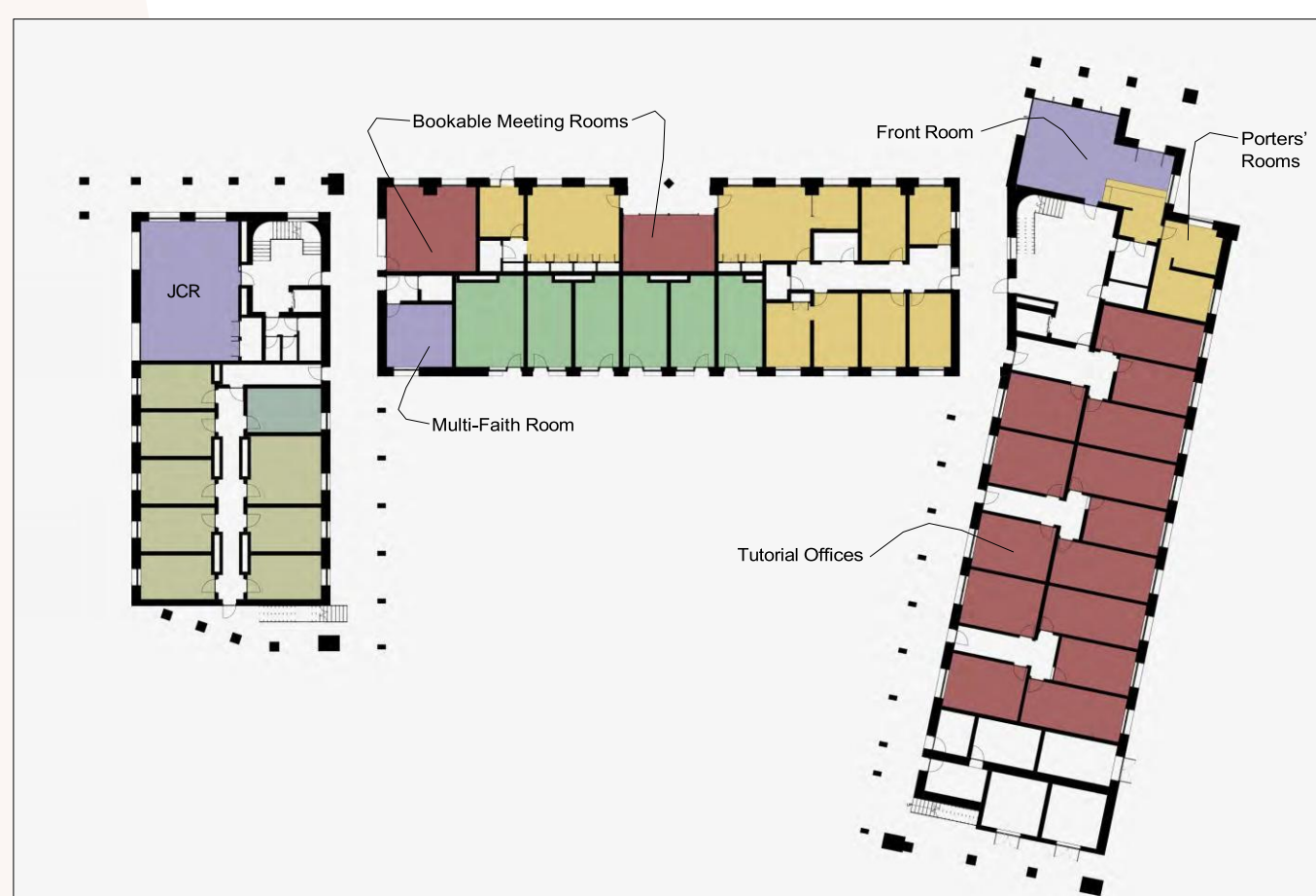

South Range - Indicative ground floor arrangement





The South Range – learning from Champneys

The following five steps demonstrate how the architect Basil Champneys' design of the North Range has guided our approach to the new South Range.

1. A new tower

The South Range's quad facing gable ends are shaped to become part of the recognisable family of features associated with Mansfield College.

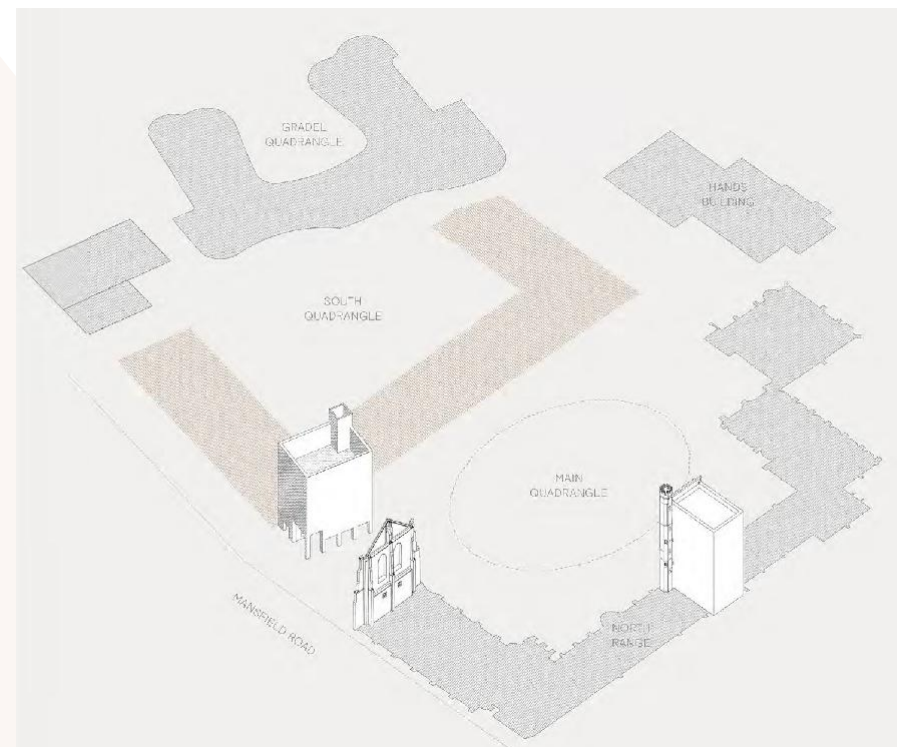

1. A new tower

2. Anchored corners and framed entrance

The north-east corner steps inwards, aligning with the Chapel to create a welcoming entrance court. This design creates a strong sense of unity between the new and historic buildings, using both to frame the outdoor space. Additionally, views of the Chapel gable and North Range are carefully preserved.

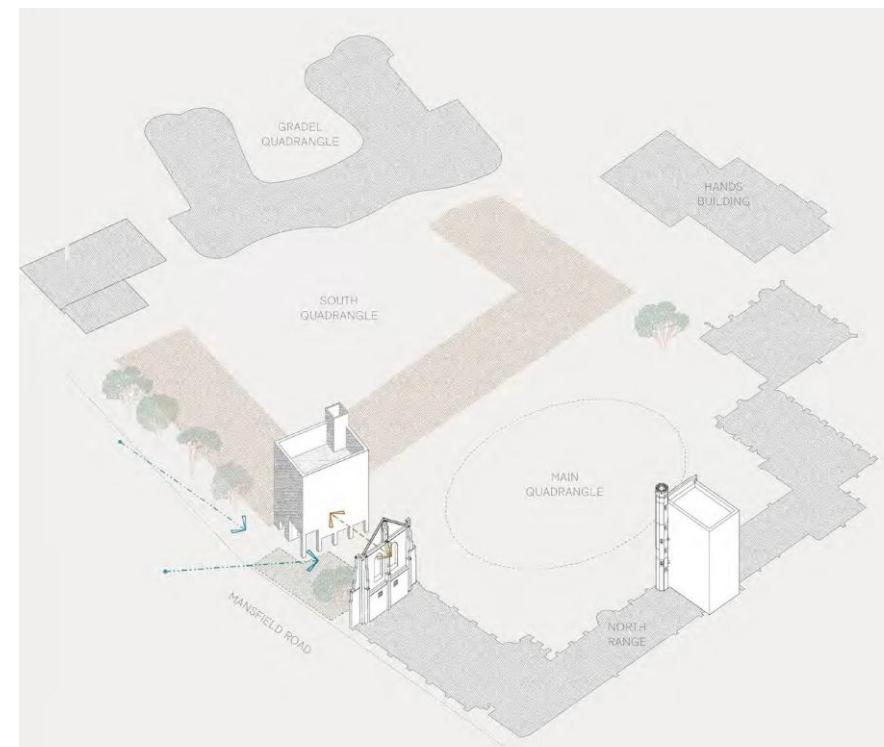

2. Anchored corners and framed entrance

3. Distinctive functions

The tower acts as a bookend to both the East Wing and Spine, negotiating the point at which they meet and marking the point of entry to the College with measured confidence.

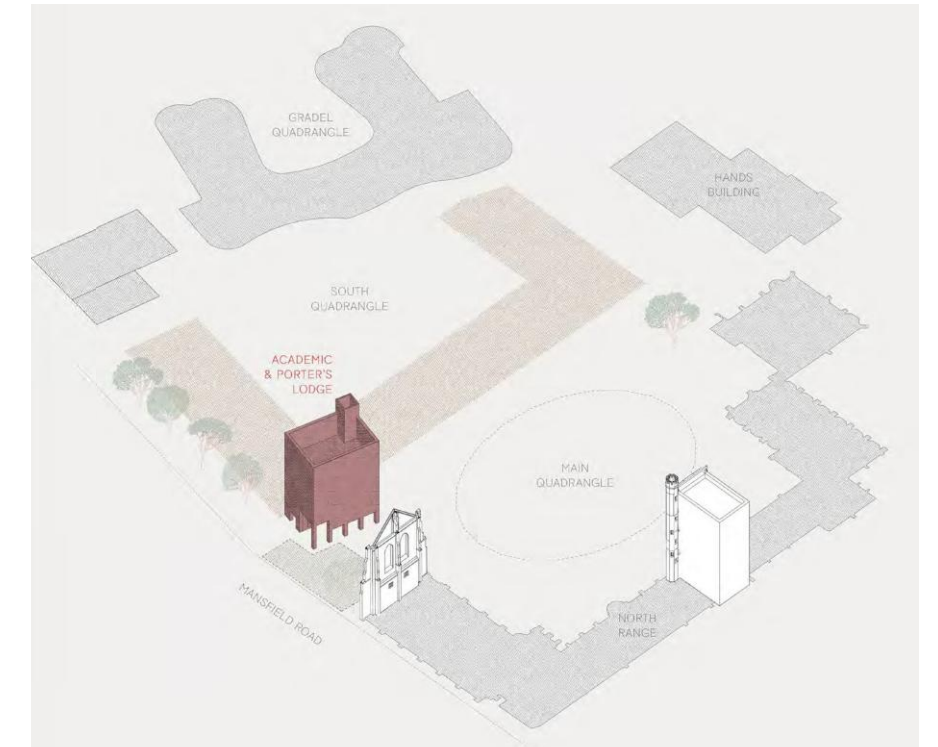

3. Distinctive functions

4. Hard-working wings and spine

The South Range is designed around a central 'spine' with branching 'wings' that allow for flexible use and easy adaptation. Its efficient structural grid supports student bedrooms in a home-like layout but can also be opened up to create larger spaces for academic use if needed in the future. This flexible design approach underlies the ambition for the South Range to serve the College effectively for over 100 years.

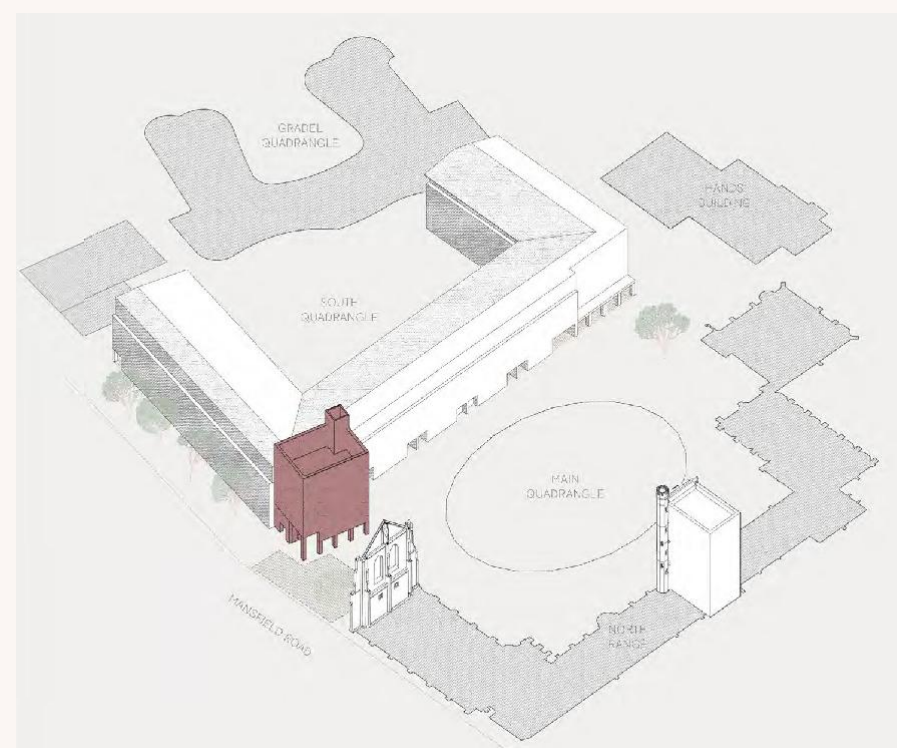

4. Hard-working wings and spine

5. Passages and connectivity

Permeability is a key focus, connecting the northern and southern sides of the estate. This approach integrates new and existing spaces, enhances circulation, improves visibility between areas, and continues Oxford's tradition of intriguing doorways and passageways. Additionally, passageways and colonnades offer sheltered outdoor spaces.

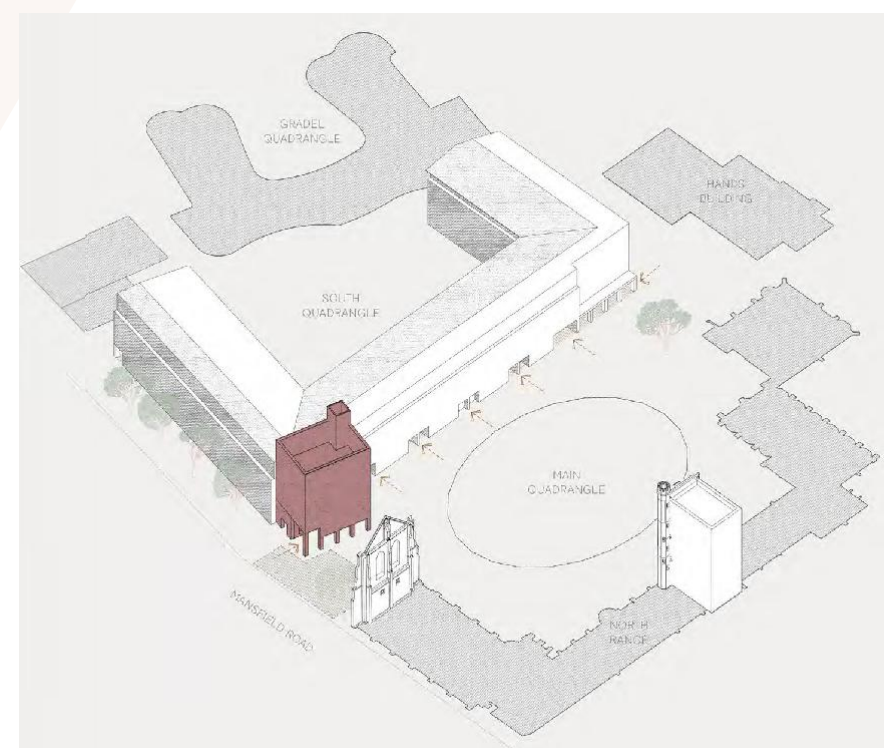

5. Passages and connectivity

The South Range – prospective views

The plan and prospective views shown here are the result of extensive design development and consultation with Oxford City Council, the Oxford Design Review Panel, Historic England, local residents and members of the College community.

This collaborative process has helped shape a proposal that is sensitive to its historic context, responsive to feedback and aligned with the College's long-term needs.

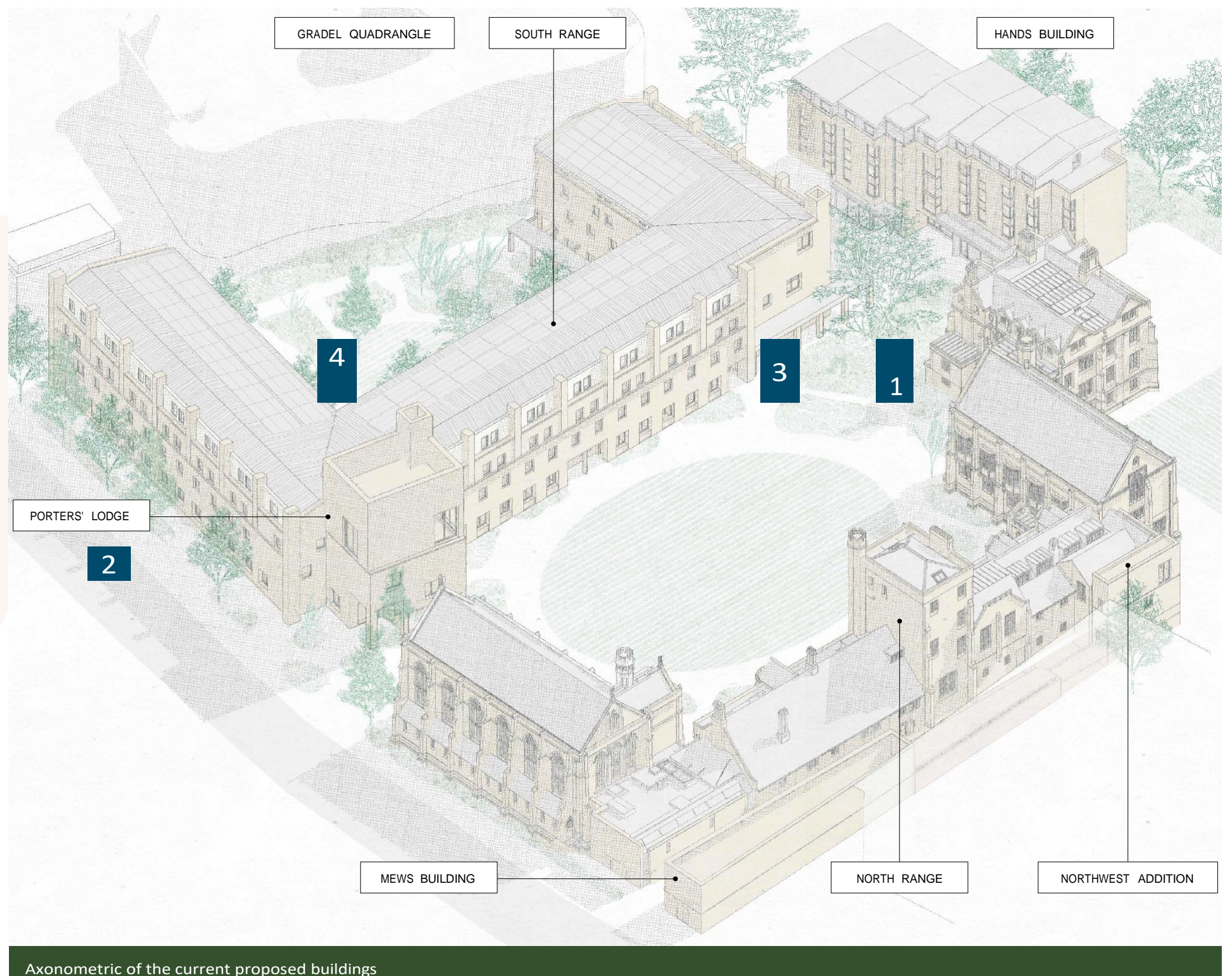

1 Proposed view of Main Quad from the Principal's Lodgings

2 Proposed view of current east wing proposal from Mansfield Road

3 Proposed view of the passage between the Spine and West Wing

4 Proposed view of the loggia from the South Quad

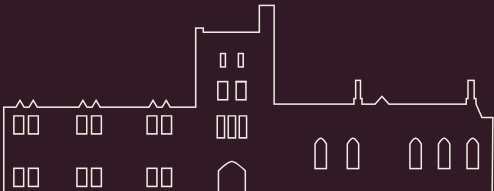

An open and accessible landscape













Equally important are the College grounds, which, along with our buildings, reflect Mansfield’s commitment to being an open and welcoming College.

We are proud of our Main Quad, a key part of the college’s identity. By contrast the Legacy Garden, though more intimate, currently suffers from limited light, poor accessibility due to level changes and disruption from Staircase E and bike parking.

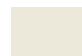
As the plan below shows, our evidence-based decision to replace the South Range enables us to introduce a new South and West Quad, that along with a holistic landscape plan for the whole estate, will provide welcoming and inclusive spaces for staff, students, neighbours and wildlife – with a goal to boost on-site biodiversity by at least 10%.

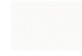

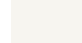
Proposed landscape plan

- | | | | |
|---|----------------------------|---|--|
|  | Tree proposed |  | Proposed tar spray and stone chippings |
|  | Tree existing |  | Proposed plant bed |
|  | Existing tree transplanted |  | Proposed lawn |
|  | Proposed cobbles |  | Centre line |
|  | Proposed recycled cobbles |  | Fence |
|  | Proposed york stone paving |  | Site boundary |



A new entrance courtyard

Back in February, we introduced our plan to create a new pocket park at our entrance on Mansfield Road.

As shown in the before and after views below, the proposed design moves the secure line to the far corner of the Chapel to create a welcoming, publicly accessible landscaped area, with the new Porters' Lodge clearly visible on the left.



View of the proposed College entrance from Mansfield Road

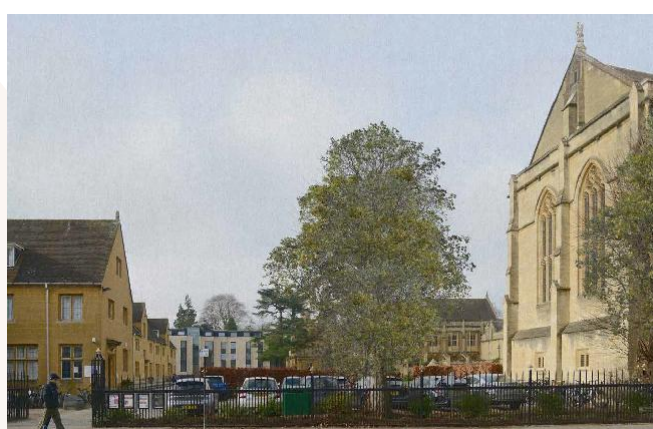

Existing entrance courtyard



View of the proposed Porters' Lodge tower and College entrance

A further new entrance is proposed at the south-east corner of the College, adjacent to the Civil War Ramparts. The design opens up generous views into the new South Quad and along the Ramparts, improving sightlines and enhancing views along the College's southern edge.



View of the existing southern boundary between Mansfield College and New College



View of the secondary College entrance and Civil War Ramparts



0800 689 5209



www.mansfield.ox.ac.uk/estatetransformationproject



Freepost CONSULTATION REPLY
(no stamp required)



consultation@mansfieldproject.co.uk



Northern area improvements

Back in February, we shared our vision to ensure our heritage buildings are fit for the future – supporting our operational needs while allowing their beauty to be shared and celebrated by all.

We introduced our proposal to make better use of the space behind the North Range. As shown in the plan below, this includes a new two-storey Mews Building designed to significantly enhance the estate’s functionality, accessibility and sustainability.

- **Mews Building:** A new detached Mews Building along the northern boundary will house catering ancillary facilities and the necessary plant to help decarbonise our heritage buildings.
- **Northwest addition:** A passenger lift extension will further our ambition to provide step-free access to all feasible floors of the Champneys buildings. This includes our beautiful Main Library.
- **Bike storage:** Around 150 mainly double-stacked bike stands will provide secure, convenient cycling facilities for students and staff.

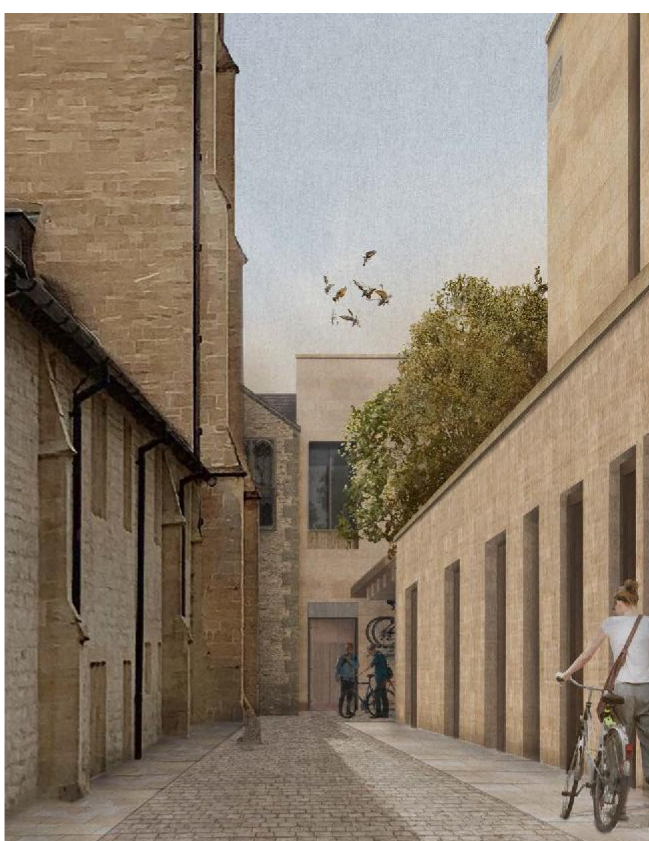

Mews Building - view from within the proposed new lane

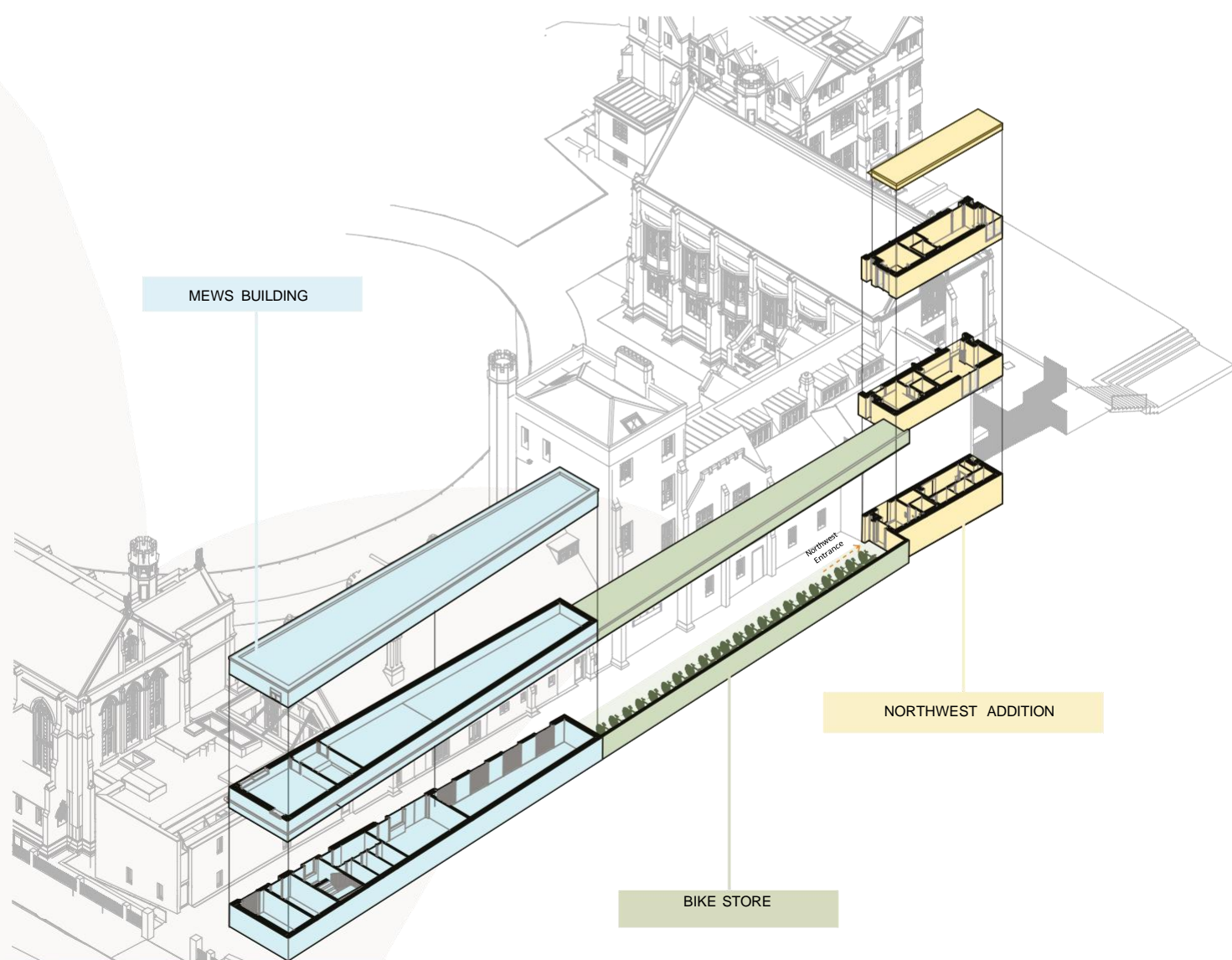

The Mews Building and northwest addition



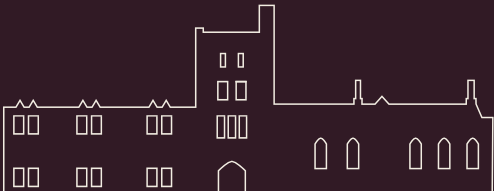

Creating a sustainable place

We are deeply committed to improving environmental sustainability in all our activities. With a primary focus on enhancing the energy efficiency of our estate, we believe that every step we take can create a lasting positive impact on our community and the environment.

As shown in the first diagram below, our holistic estate approach is guided by targets that will drive the project team toward achieving Net Zero Operational Carbon for new buildings, and a Net Zero Carbon in Operation estate by 2050.

Back in February, we also discussed how achieving a sustainable financial model will enable us to reinvest in improving the sustainability of our heritage assets. The second plan highlights one element of the proposed works for the North Range as part of this commitment.

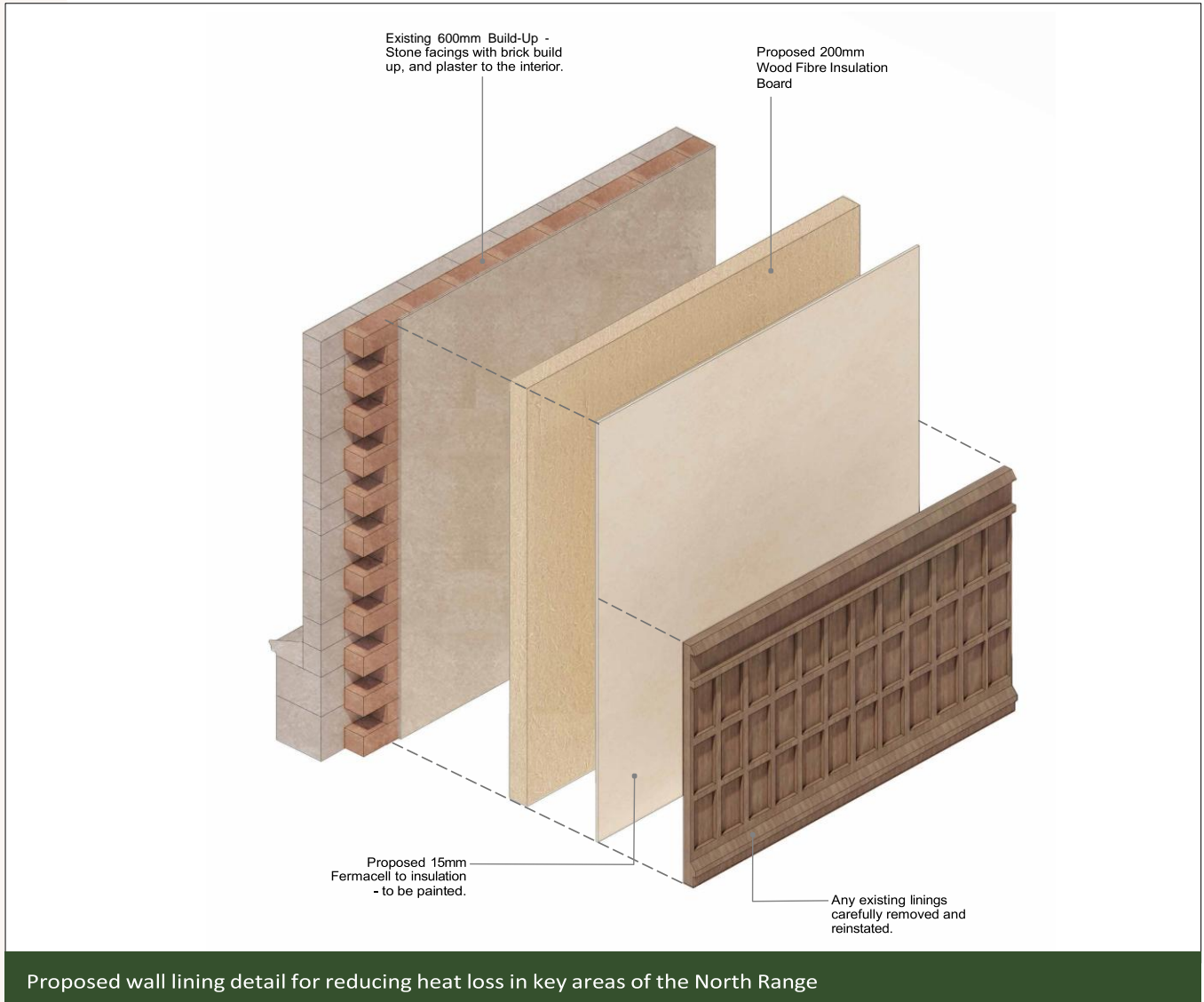
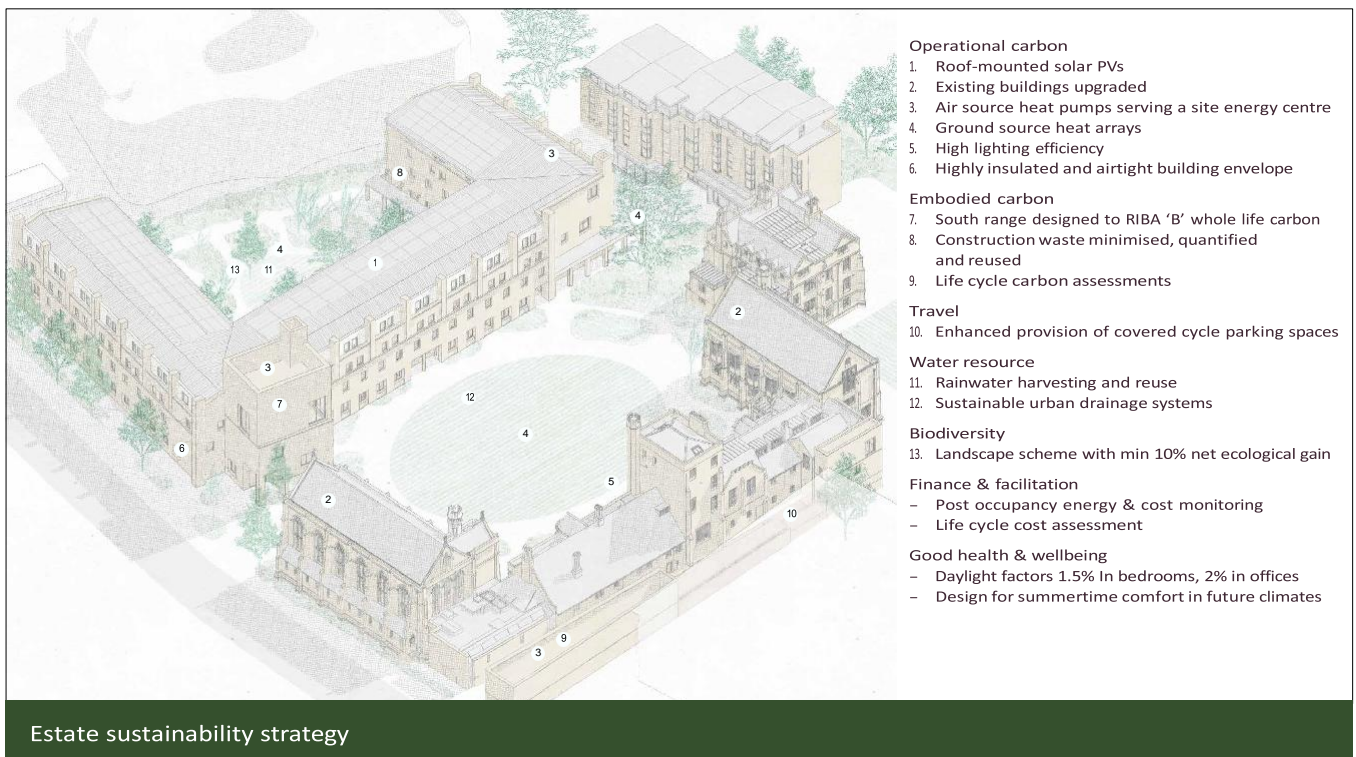



The College experience

Life at Mansfield is about more than just academic excellence – it is about community, opportunity and belonging.

Our Estate Transformation Project will enhance that experience, creating spaces that reflect our values and support the next generation of Mansfield students.

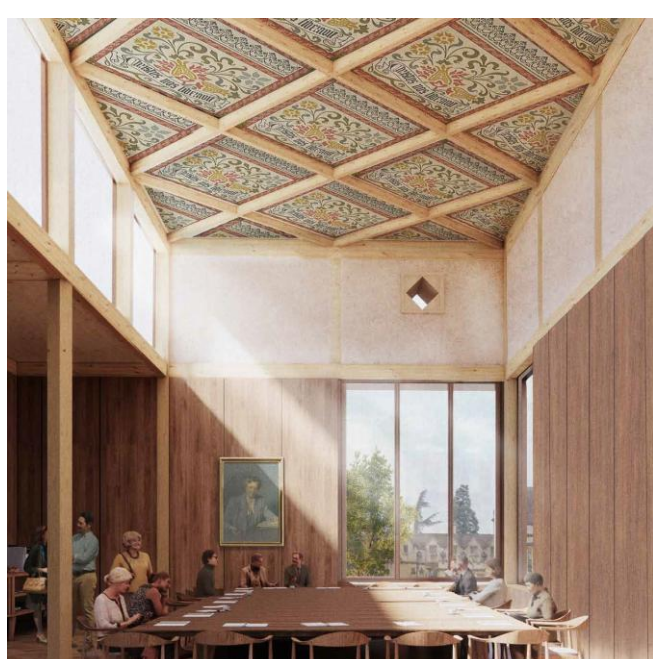

View of the Gallery room on the third floor of the Porters' Lodge Tower



View of the Porters' Lodge front room



View of the current JCR re-purposed for flexible lecture, teaching and events space



View of a typical academic tutorial office



View of the current MCR re-purposed for additional library space



0800 689 5209



www.mansfield.ox.ac.uk/estatetransformationproject



Freepost CONSULTATION REPLY
(no stamp required)



consultation@mansfieldproject.co.uk



Ensuring Mansfield thrives for generations to come

Mansfield's core mission is to provide life-changing opportunities for talented students from all backgrounds to study and thrive at Oxford.

This project is essential for enhancing our financial resilience and operating model and, as an historically underendowed College, securing our financial future is vital to ensuring Mansfield can continue to lead the way on widening participation at Oxford.

The updated plans on display today will:



Provide high-quality, College-owned accommodation for the full undergraduate and visiting student body.



Introduce additional teaching, academic and staff welfare space.



Make our heritage assets more accessible, comfortable and welcoming to all.



Introduce a new entrance courtyard and open views to the Civil War Ramparts.



Provide welcoming and inclusive landscape spaces for staff, students, neighbours and wildlife — with a goal to boost on-site biodiversity by at least 10%.



Create more space for commercial bookings and academic events — supporting a steady income that can be reinvested, while welcoming a wider and more diverse audience to enjoy our facilities.



Reduce costly external accommodation rentals and operating expenses.



Free up housing in the city and reduce pressure on Oxford's housing market.



Enhance the environmental performance of our buildings, reducing energy consumption and lowering our operational costs.



0800 689 5209



www.mansfield.ox.ac.uk/estatetransformationproject



Freepost CONSULTATION REPLY
(no stamp required)



consultation@mansfieldproject.co.uk

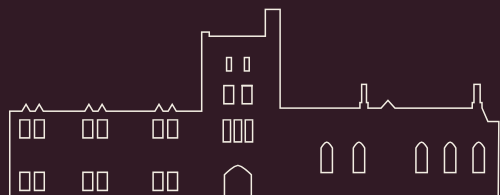

Thank you and next steps

Thank you for taking the time to come to our consultation event today.

We would be grateful if you would take a couple of minutes to complete our feedback form to let us know your thoughts, either here at the event, or later by visiting our website.

The closing date for feedback is midnight on Thursday 26 June.
Visit our website www.mansfield.ox.ac.uk/estatetransformationproject



Scan to give your feedback

If there is a local group, charity or business you think we should talk to, let us know on your feedback form. Thank you for helping us reach our whole community.

Indicative timeline

